

10.0-15.0 GHz 2 Way Power Divider

Part Number: AM1000-15000PD2-946

Electrical Specifications

Frequency Range: 10.0-15.0 GHz
Insertion Loss: 0.4 dB Max.
Isolation: 20 dB Min.
Amplitude Balance: 0.2 dB Max.
Phase Balance: 4° Max.
VSWR: 1.40:1 Max.
Power Rating: 30 Watts Max.

Mechanical

Mounting Method: Threaded Mounting Holes
Connector Type: SMA
Dimensions: 1.04 x 0.80 x 0.37 in.

Environmental

Operating Temperature: -40 to +85°C
Storage Temperature: -55 to +125°C
Shock: 20 G. 11 ms.
Vibration: 20 G. 5 to 200 Hz.

Outline Drawing:

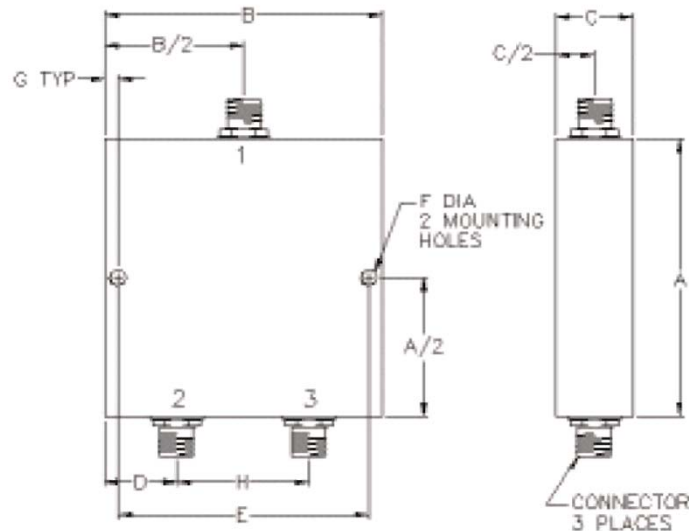

A: 0.80	B: 1.04
C: 0.38	D: 0.27
E: 0.80	F: 0.125
G: 0.12	H: 0.50