

Electrical Specifications

Frequency Range: 1.0-27.0 GHz

Insertion Loss : 2.5 dB Max.

Isolation: 15 dB Min.

Amplitude Balance: 0.5dB Max.

Phase Balance: 8.0° Max.

VSWR: 1.80:1 Max.

Input Power: 10 Watt Max.

Mechanical

Mounting Method: Threaded Mounting Holes

Connector Type: SMA

Dimensions: 1.00 x 3.90 x 0.40 in.

Environmental

Operating Temperature: -40 to +85°C

Storage Temperature: -55 to +95°C

Shock: 20 G. 11ms

Vibration: 20 G. 5 to 200 MHz

Outline Drawing:

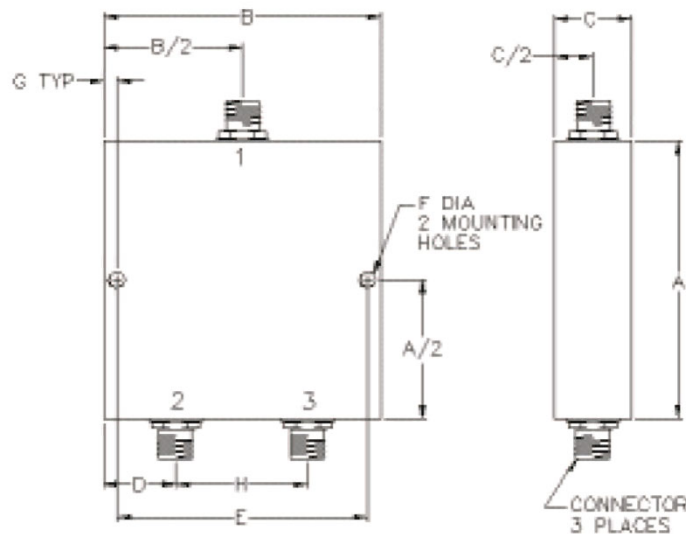

A: 3.90	B: 1.00
C: 0.40	D: 0.25
E: 0.80	F: 0.125
G: 0.10	H: 0.50